

Parts List			
Item	Qty	Description	Material
1	1	Vertical Single Base	Steel
2	2	Side Support	Steel
3	1	Cross Support	Steel
4	2	Single Top Plate	Steel
5	1	Fly Wheel Twin	Brass
6	2	Slider Tube	Steel
7	2	Chest	Brass
8	2	Cylinder	Brass
9	2	Cylinder Plate Outer	Brass
10	2	Cylinder Plate Inner	Brass
11	2	Piston	Brass
12	4	Piston Ring	Nylon
13	2	Packing Nut	Brass
14	2	Valve	Stainless Steel
15	2	Eccentric Rod Short	Brass
16	2	Ecc Wheel Plate	Steel
17	2	Ecc Wheel	Steel
18	2	Main Bearing Lower	Bronze
19	2	Main Bearing Upper	Bronze
20	2	Tube Slider	Steel
21	2	Slider Pin	Steel
22	2	Conn Rod Short	Stainless Steel
23	4	Conn Rod Bearing Half	Bronze
24	2	Conn Rod Keep	Steel
25	1	Crank V Twin	Steel
26	2	Piston Shaft	Stainless Steel
27	2	Stub Pipe	Brass
28	2	Chest Plug	Brass
29	2	Valve Screw M2x10mm	Stainless Steel
30	2	Nut M2	Stainless Steel
31	12	Screw M5x15mm	Stainless Steel
32	12	Screw M3x15mm	Stainless Steel
33	8	Cylinder Screw M3x40mm	Stainless Steel
34	8	Tube Screw M3x10mm	Stainless Steel
35	4	Ecc Wheel Screw M3x4mm	Stainless Steel
36	4	Conn Rod Screw M2x12mm	Stainless Steel
37	4	Nut M3	Stainless Steel
38	4	Nut M5	Stainless Steel
39	1	Grub Screw M3x4mm	Stainless Steel
40	2	Grub Screw M3x3mm	Stainless Steel

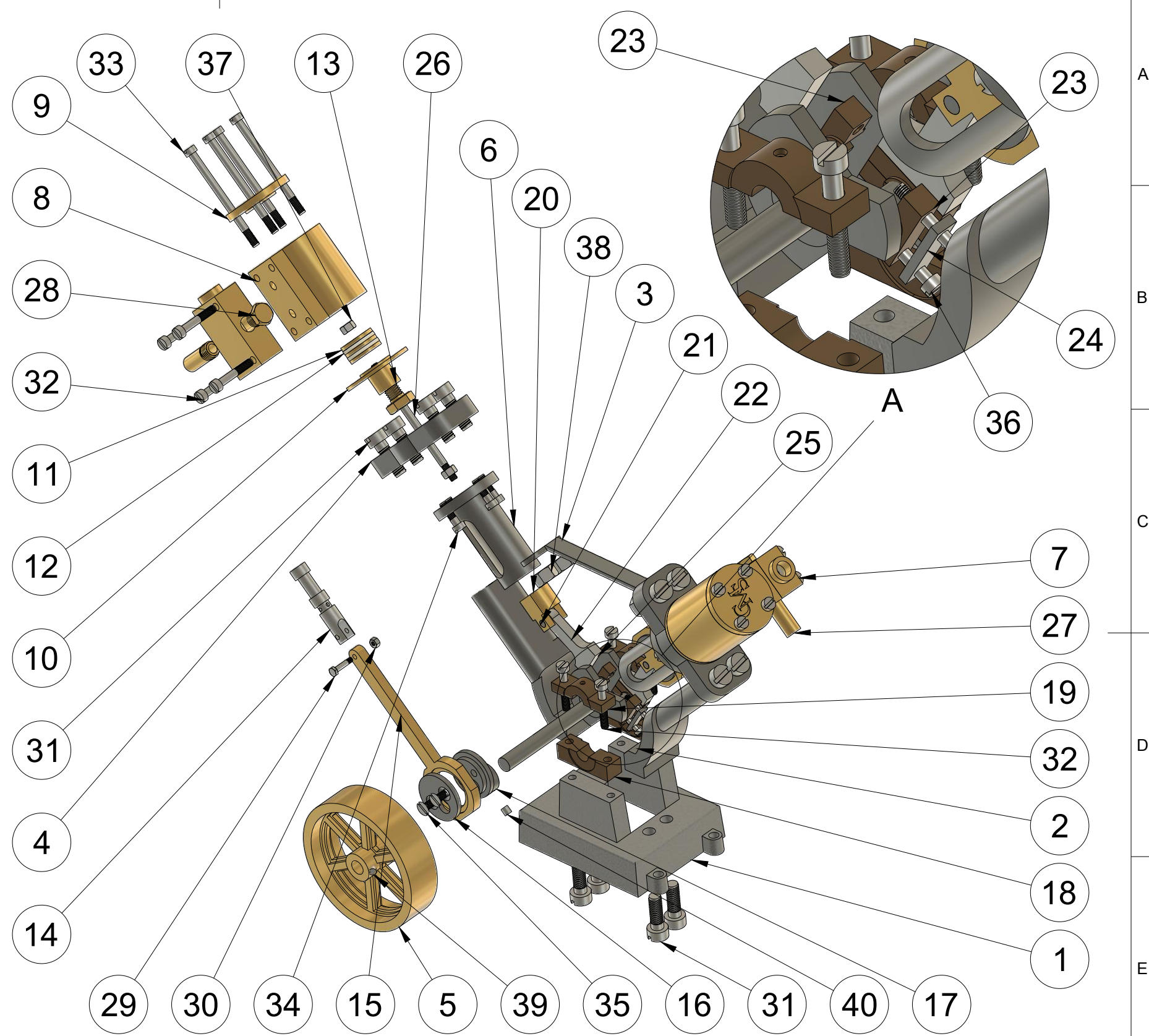

Drawn by: Simon Rowley	File Name: V Twin v1_0	Date: 10 June 2019	Scale:
Copyright Simon Rowley Chiltern Model Steam	Part Name: V Twin Cylinder Marine Engine Assembly Drawing		
Material:	Rev: 1.0	Part Number:	